

## Product Installation Guidelines & Scope of Use

Version 1, 15 December 2025, Page 1 of 6  
Document No: 001.00.10.42

# CliniLever® CP-BS Lead Safe™ Hospital Washing Machine Tap

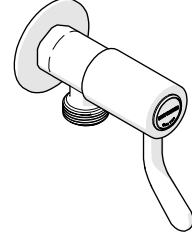

### PRODUCTS

Item Code	Description	Headworks
102.26.22.01	CliniLever® CP-BS Lead Safe™ Hospital Washing Machine Tap 80 C/D - Cold	Ceramic Disc
102.26.22.02	CliniLever® CP-BS Lead Safe™ Hospital Washing Machine Tap 80 C/D - Hot	Ceramic Disc
102.26.12.01	CliniLever® CP-BS Lead Safe™ Hospital Washing Machine Tap 80 J/V - Cold	Jumper Valve
102.26.12.02	CliniLever® CP-BS Lead Safe™ Hospital Washing Machine Tap 80 J/V - Hot	Jumper Valve

### SPECIFICATIONS

- Contra-rotating handles for easy use
- Smooth round design to facilitate easy cleaning and help reduce dirt and bacterial growth
- Chrome plated finish for easy cleaning and added durability
- The main body is made of lead free\* dezincification resistant (DR) brass with a fixed outlet.
- Quick action SBA's includes brass jumper valve / ceramic disc component, with red and blue indicator button on 80mm lever action handles.

**IMPORTANT:** All CliniLever® healthcare taps are tested in accordance with AS 3718 and leave our premises in good working order.

\*Our Lead Safe™ product range is compliant with the Lead-Free Requirements of the NCC 2022 Vol. Three, Clause A5G4(2) and NSF/ANSI 372.

**WARNINGS:** Special attentions to be paid on notes, photos, images, or drawings of assembly steps marked with the warning symbol.



### TECHNICAL DATA

Inlet	G 1/2" - Female	
Outlet	G 3/4" - Male	
Working Pressure Range (kPa)	Min	50
	Max	500
Working Temperature Range (°C)	Min	5
	Max	65
Nominal Flow Rate (LPM)	N/A	
Finish	Chrome	

**NOTE:** Galvin Engineering continually strive to improve their products. Specifications may change without notice.

## TOOLS REQUIRED

- Spanner
- Hex key
- Thread tape

## PRE-INSTALLATION - MOUNTING DETAILS

### Wall Spud

- Wall spuds must be 1/2" BSP MI and protrude from the finished wall by no more than 15mm

**Note:** In some situations, a male thread connection on the tap may be more suited. If so, please contact Galvin Engineering. ⚠

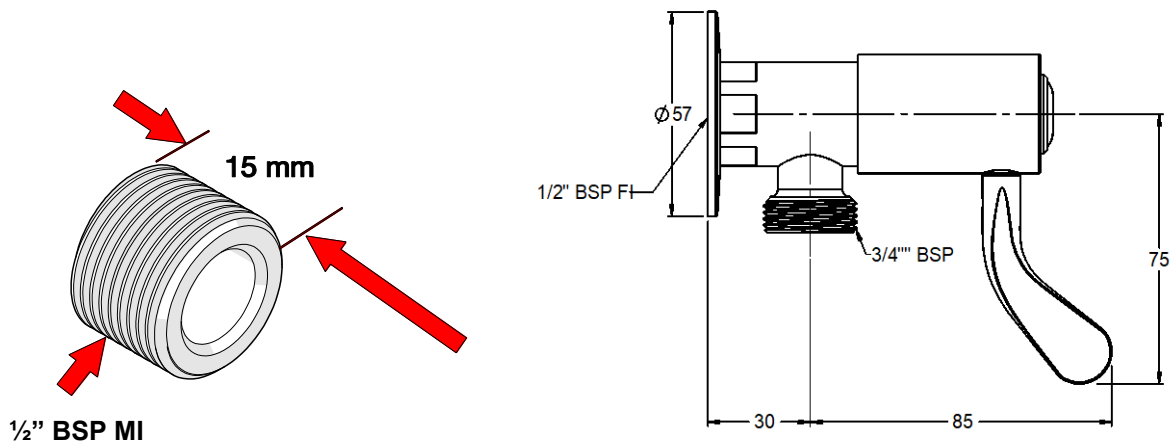

## INSTALLATION

**IMPORTANT:** Galvin Engineering products must be installed in accordance with these installation instructions and in accordance with AS/NZS 3500, the PCA and your local regulatory requirements. Water and/or electrical supply conditions must also comply to the applicable national and/or state standards. Failing to comply with these provisions shall void the product warranty and may affect the performance of the product.

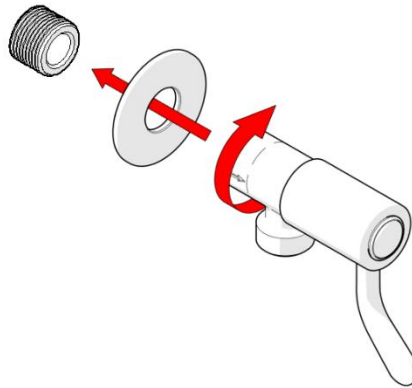

### 1. Fit washing machine body

- Fit the washing machine body assembly with the wall flange to the spud and fasten with a spanner using the wrenching flats on the body.
- Use thread tape or equivalent to ensure the connection does not leak.

**⚠ Note: Do not tighten using handle or outlet. Use wrenching flats on body.**

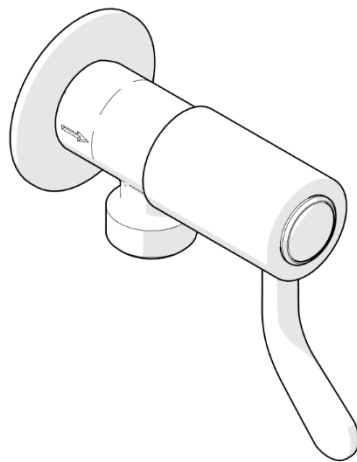

### 2. Testing

- Once fitted, check the operation of the unit, and inspect for any leaks.

## TROUBLESHOOTING

PROBLEM	CAUSE	RECTIFICATION
Taps are dripping water	Jumper valves are worn or damaged	Replace jumper valve
	Ceramic discs are worn or damaged	Remove and inspect SBA. Remove debris and/or replace SBA if damaged.
	Tap seat is damaged	Refurbish tap seat using a reseating tool.
Water is leaking from spindle	O-ring on jumper valve spindle is damaged or worn	Replace o-ring
Water is not flowing from tap	Water is turned off	Turn water on
	Aerator or flow regulator is blocked by debris	Remove aerator and/or flow regulator from tap and remove debris. Install an inline strainer.
Spindle is difficult to turn (jumper valve)	Build up of scale on spindle, spindle worn or o-ring has been damaged	Remove jumper valve, clean and regrease. Replace o-ring. Complete SBA may need to be replaced.
Handle is loose	Screw has come loose	Tighten handle screw

## SERVICE AND MAINTENANCE

### JUMPER VALVE TAPWARE

1. Turn off the water supply and turn on the tap handle to drain water from the bodies.
2. Remove the temperature indicator from the handle.
3. Remove the handle from the tap.
4. Unscrew the top assembly from the body.
5. Check the o-ring on the spindle and the jumper valve for wear and damage. Replace if required.
6. Clean the spindle and body of any debris.
7. Place a new o-ring (if required) onto the spindle and re-grease with potable water approved grease.
8. Re-assemble components and re-install as per installation guidelines.

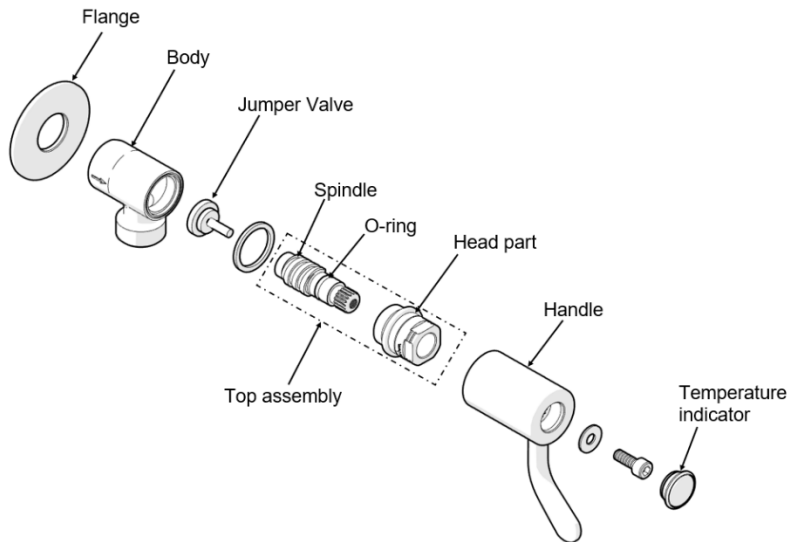

### CERAMIC DISC TAPWARE

1. Turn off the water supply and turn on the tap handle to drain water from the bodies.
2. Remove the temperature indicator from the handle.
3. Remove the handle from the tap.
4. Unscrew the ceramic head part from the body.
5. Check the o-ring on the ceramic head part for wear and damage. Replace if required.
6. Clean the head part and the body of any debris.
7. Replace the ceramic head part and hand tighten back into the body.
8. Re-assemble components and re-install as per installation guidelines.

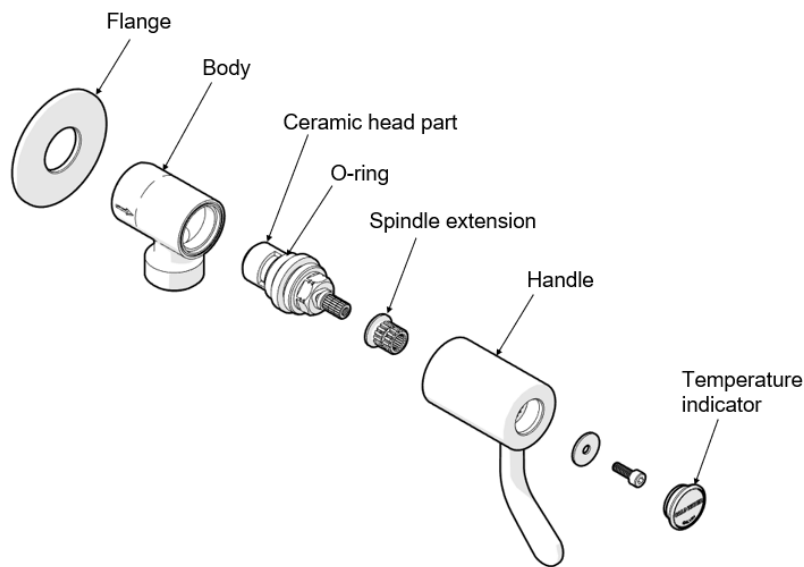

### WARRANTY

Galvin Engineering products are covered under our Manufacturer's Warranty. Galvin Engineering products must be installed in accordance with the installation instructions and in accordance with AS/NZS 3500 and NCC Volume Three, relevant Australian Standards and local authorities applicable to product being installed. Water and electrical supply conditions must also comply to the applicable national and/or state standards, failing to comply with these provisions may void the product warranty and affect performance of the product.

Please visit [www.galvinengineering.com.au](http://www.galvinengineering.com.au) to view the full warranty, our Installation Compliance and Maintenance & Cleaning information as well as any other additional information.

Within Australia: **1300 514 074** Outside Australia: P: **+61 (0)8 9338 2344**

F: **+61 (0)8 9338 2340**

[sales@galvinengineering.com.au](mailto:sales@galvinengineering.com.au)

[www.galvinengineering.com.au](http://www.galvinengineering.com.au)

ABN: 78 008 719 382

PERTH | SYDNEY | MELBOURNE | BRISBANE | ADELAIDE

